

PBA-210 (A)

- ❖ 此系列為完全氣壓驅動，速度快，特別適合各種小容器或棒棒冰容器之製造。產量高、具經濟效益，維護容易。
- ❖ RELAY電控系統。
- ❖ This series of machines are fully pneumatic driven featuring high speed motion. Especially ideal for providing small containers and popsicle containers. The series features high production output, highly economic efficiency and easy maintenance.
- ❖ RELAY CONTROL SYSTEM

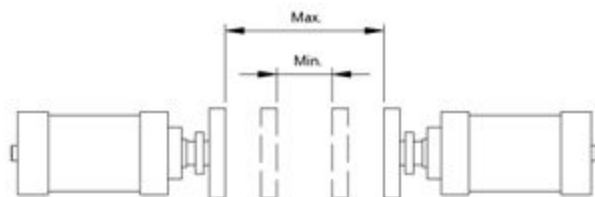

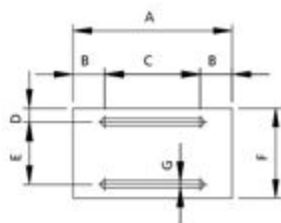

模板尺寸圖

MOLD PLATEN DIMENSIONS

UNIT:mm

NO.	Max.	Min.	A	B	C	D	E	F	G
PBA-210	240	80	230	46	138	20	90	130	11

Model No.	型號	Unit	PBA-210(PE)	PBA-210A(PVC)	PBA-210A(PE)
Max. product capacity	最大產品容量	C.C.	20~300	20~300	20~300
Min. / Max. dia. of product	產品最小最大直徑	mm	10~80	10~80	10~80
Screw diameter	螺桿直徑	mm	40	40	40
Screw L / D ratio	螺桿比例		22/1	22/1	22/1
Inverter motor	普通馬達	HP	5	5	5
Screw rotating speed	螺桿轉速	r.p.m.	15~50	15~50	15~50
Extruding capacity	押出量	kg/hr	14	16	14
Outer diameter of die mouth	模嘴外徑	mm	40	46	40
Open close daylight	開閉模極限	mm	80~240	80~240	80~240
Dry cycle	空循環	sec.	2	2	2
Pressure of air	空氣壓力	kg/cm ²	4~6	4~6	4~6
Compressed air consumption	空氣消耗量	L/min	400	600	500
Total power consumption	總電力	kw/h	8	9	8
Machine net weight	機械淨重	kg	500	600	600
Gross weight	裝箱毛重	kg	900	1000	1000
Machine dimensions	機械尺寸	m	1.8x1.6x1.9	1.8x1.6x1.9	1.8x1.6x1.9

以上規格如因設計變更恕不另行通知

All specifications and designs are subject to change without notice.

PBA-210 (A)