

PBS-605 / 705 (S / D / T / Q)

- ❖ 高強度平移式模架結合滾珠線性滑軌設計，速度快、穩定性高。配合打溢料設備及機械手，可全自動高效率生產。
- ❖ 10" TFT彩色LCD觸控螢幕人機介面電控系統，功能強、操作簡易、富人性化。
- ❖ Durable and horizontal traveling mold carriage combined with linear motion guides for maximum stability. The series is excellent for producing medium and large sized containers. Available to equip with an auto deflashing device and take-out robot to achieve fully automatic and highly efficient production.
- ❖ 10" TFT colorful LCD touch screen with human-machine interface control system. It provides powerful functions, maximum operational convenience and user-friendly operation.



Model No.

Max. product capacity

Min. / Max. dia. of product

Screw diameter

Screw L / D ratio

Inverter motor

Screw rotating speed

Extruding capacity

Outer diameter of die mouth

Mould center distance

Clamping force

Oil hydraulic drive motor

Dry cycle

Air Pressure

Air consumption

Total power consumption

Machine net weight

Gross weight

Machine dimensions

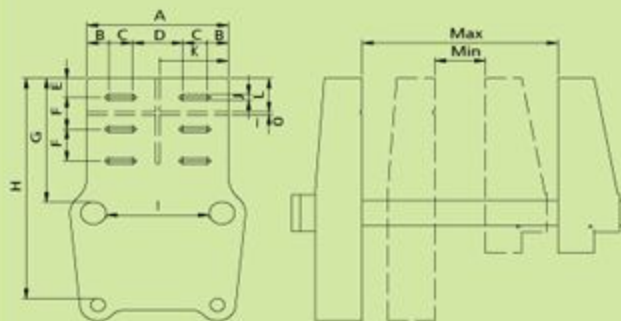

模板尺寸圖

MOLD PLATEN DIMENSIONS

UNIT:mm

NO.	PBS-605	PBS-705	NO.	PBS-605	PBS-705
Max.	540	650	F	100	180
Min.	140	200	G	410	430
A	390	440	H	715	740
B	60	80	I	280	330
C	65	60	J	18	18
D	140	160	K	190	215
E	60	60	L	105	105

配合模內貼標機之使用開關模尺寸另訂
For use with in-mold labeling machine.
Open-close clamping mold is specified upon request.

型號	Unit	PBS-605S	PBS-605D	PBS-605T	PBS-605Q	PBS-705S	PBS-705D	PBS-705T	PBS-705Q
最大產品容量	C.C.	1,000-5,000	450-1,800	200-1,000	50-500	2,500-10,000	600-2,700	450-1,800	200-1,000
產品最小最大直徑	mm	75-200	50-120	30-100	20-80	100-250	60-140	50-120	30-100
螺桿直徑	mm	65	65	65	65	75	75	75	75
螺桿比例	L/D	24/1	24/1	24/1	24/1	24/1	24/1	24/1	24/1
普通馬達	HP	20	20	20	20	40	40	40	40
螺桿轉速	r.p.m.	15-65	15-65	15-65	15-65	15-65	15-65	15-65	15-65
押出量	kg/hr	55	55	55	55	75	75	75	75
模嘴外徑	mm	150	65	50	40	200	80	65	50
模中心距	mm	-	140	120	100	-	160	140	120
鎖模壓力	ton	8.8	8.8	8.8	8.8	13.0	13.0	13.0	13.0
泵浦驅動馬達	HP	15	15	15	15	25	25	25	25
空循環	sec.	4.2	4.2	5.0	5.0	5.0	5.0	5.2	5.2
空氣壓力	kg/cm ²	6-8	6-8	6-8	6-8	6-8	6-8	6-8	6-8
空氣消耗量	L/min	750	750	750	750	1200	1200	1,200	1,200
總電力	kw/h	38.0	40.5	42.0	46.7	64.9	66.4	67.3	75.0
機械淨重	kg	4,800	4,800	4,800	4,800	5,000	5,000	6,500	6,500
裝箱毛重	kg	5,500	5,500	5,500	5,500	6,000	6,000	7,000	7,000
機械尺寸	m	3.7x2.5x2.5	3.7x2.5x2.5	3.8x2.7x2.5	3.8x2.7x2.5	4.3x2.7x2.6	4.3x2.7x2.6	4.3x2.7x2.8	4.3x2.7x2.8

以上規格如因設計變更恕不另行通知
All specifications and designs are subject to change without notice.