

PBS-905

(S / D / T / Q / O)



- 強力曲肘式鎖模機構結合滾珠線性滑軌設計，穩定性高，適合中大型容器之生產。多模頭設計可高速生產中小型容器。可依客戶要求設計特殊結構，亦可生產加視窗、雙色、雙層之產品。
- 10" TFT 彩色LCD觸控螢幕人機介面電控系統，功能強、操作簡易、富人性化。
- Powerful, crank type mold clamping system combined with linear guides for maximum stability. This series is ideal for producing medium and large sized containers. Multiple die head configuration is especially ideal for producing medium and small sized containers at high production speed. Custom machine configurations are available. Also available to produce product with visi-stripe, two color and two layers.
- 10" TFT colorful LCD touch screen with human-machine interface control system. It provides powerful functions, maximum operational convenience and user-friendly operation.



此機台包含模內貼、白線機構及測漏機 (選配)
Machine with IML, visistripe, and leak tester (optional)

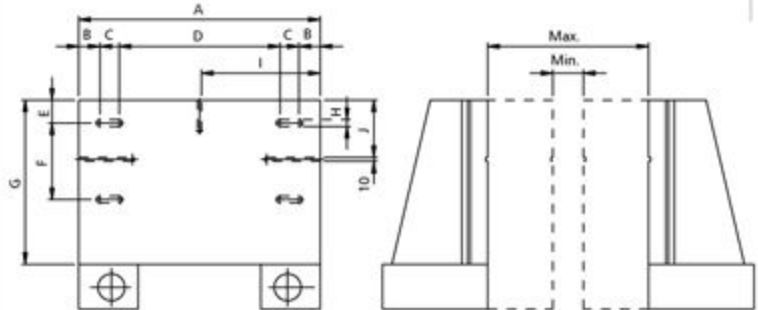

模版尺寸圖
MOLD PLATEN DIMENSIONS

UNIT:mm

NO.	Max.	Min.	A	B	C	D	E	F	G	H	I	J
PBS-905S,D	640	240	450	65	50	220	60	220	449	18	220	165
PBS-905Q	640	240	550	55	50	340	70	200	489	18	270	180

配合模內貼標機之使用、開關模尺寸另訂
For use with in-mold labeling machine. Open-close clamping mold is specified upon request.

Model No.	型號	Unit	PBS-905S	PBS-905D	PBS-905T	PBS-905Q	PBS-905O
Max. product capacity	最大產品容量	C.C.	10,000-20,000	1,500-5,000	600-2,700	450-1,800	300-500
Min. / Max. dia. of product	產品最小最大直徑	mm	150-300	80-180	60-140	50-120	30-60
Screw diameter	螺桿直徑	mm	90	90	90	90	90
Screw L / D ratio	螺桿比例		24/1	24/1	24/1	24/1	24/1
Inverter motor	普通馬達	HP	60	60	60	60	60
Screw rotating speed	螺桿轉速	r.p.m.	15-65	15-65	15-65	15-65	15-65
Extruding capacity	押出量	kg/hr	140	140	140	140	140
Outer diameter of die mouth	模嘴外徑	mm	240	135	80	65	35
Mould center distance	模中心距	mm	~	250	160	140	80
Clamping force	鎖模壓力	ton	16.8	16.8	16.8	16.8	16.8
Oil hydraulic drive motor	泵浦驅動馬達	HP	30	30	30	30	30
Dry cycle	空循環	sec.	5.7	5.7	6.0	6.0	6.5
Pressure of air	空氣壓力	kg/cm ²	6-8	6-8	6-8	6-8	6-8
Compressed air consumption	空氣消耗量	L/min	1,500	1,500	1,500	1,500	1,500
Total power consumption	總電力	kw/h	96.0	94.0	95.7	99.2	101.0
Machine net weight	機械淨重	kg	10,000	12,000	12,000	12,000	12,000
Gross weight	裝箱毛重	kg	11,500	13,000	13,000	13,000	13,000
Machine dimensions	機械尺寸	m	5.6x4.4x3.5	5.1x3.1x2.9	5.1x3.1x2.9	5.3x2.5x2.4	5.3x2.5x2.4

以上規格如因設計變更恕不另行通知
All specifications and designs are subject to change without notice.